

## KS Connectors DC~35GHz

Connectable to  
SMA, K, 3.5mm

KS connectors have high performance up to 35GHz and compatible with SMA connector or 3.5mm connector.  
KS connectors are economical type of K connector with reliable performance.

Specifications		MIL-STD-348A	
Nominal impedance		50Ω	
VSWR		DC~35GHz 1.05+0.007f max f:GHz	
Insulation resistance		1000MΩ min at DC 500V	
Dielectric withstanding voltage		AC 500V 1 minute	
Temperature range		-55°C ~ +125°C	
Coupling nut mating torque		10kgf (90N cm) max	
Contact mating force		0.49N (50gf) min	
Contact durability		less than 6mΩ after 500 matings	
Material	Shell	Stainless steel	Passivated, Gold plated, Nickel plated
	Coupling nut	Brass	
	Center Contact	Beryllium copper	Heat treated, Gold plated

Specifications may be subject to change without notice.

### Interface Dimensions

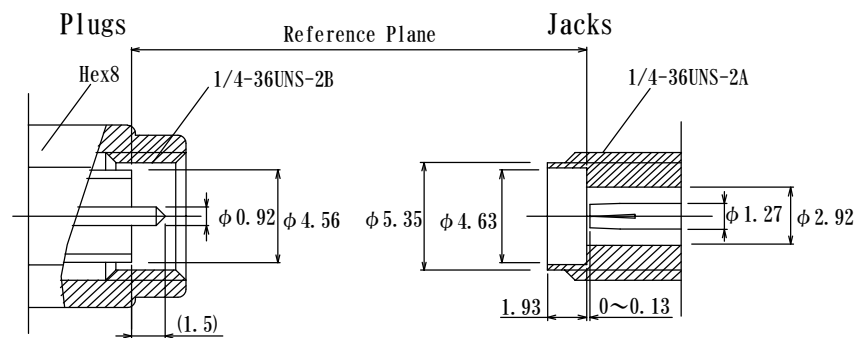

### Semi-rigid cable Plugs, Solder direct type

KSP-22S  
KSP-16S  
KSP-12S

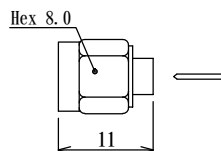

Part No.	Applicable Cable
KSP-22S	RG-405/U 2.19mm/0.086"
KSP-16S	SX-16 1.6mm/0.063"
KSP-12S	SX-12 1.19mm/0.047"

●SUS Au, Nut:Pa

### Semi-rigid cable Plugs, Solder Clamp type

KSPC-22S  
KSPC-16S \*  
KSPC-12S

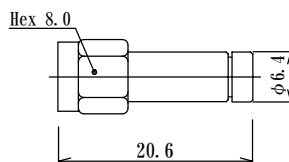

Part No.	Applicable Cable
KSPC-22S	RG-405/U 2.19mm/0.086"
KSPC-16S	SX-16 1.6mm/0.063"
KSPC-12S	SX-12 1.19mm/0.047"

●SUS Pa

\* mark product is made only upon order.

## KS Connectors DC~35GHz

### Semi-rigid cable Jacks, Solder Clamp type

KSJC-22S-G  
KSJC-16S-G \*  
KSJC-12S-G

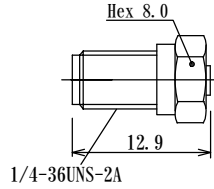

Part No.	Applicable Cable
KSJC-22S-G	RG-405/U 2.19mm/0.086"
KSJC-16S-G	SX-16 1.6mm/0.063"
KSJC-12S-G	SX-12 1.19mm/0.047"

●SUS Au

### Flange Mount Jacks, Semi-rigid cable, Solder Clamp type

KSJR-22S-2G  
KSJR-16S-2G \*  
KSJR-12S-2G

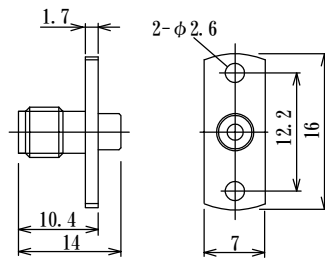

Part No.	Applicable Cable
KSJR-22S-2G	RG-405/U 2.19mm/0.086"
KSJR-16S-2G	SX-16 1.6mm/0.063"
KSJR-12S-2G	SX-12 1.19mm/0.047"

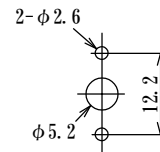

●SUS Au

### Flange Mount Adapter

Jack to Jack

KSJJ-4T  
KSJJ-4T-F22

(※)

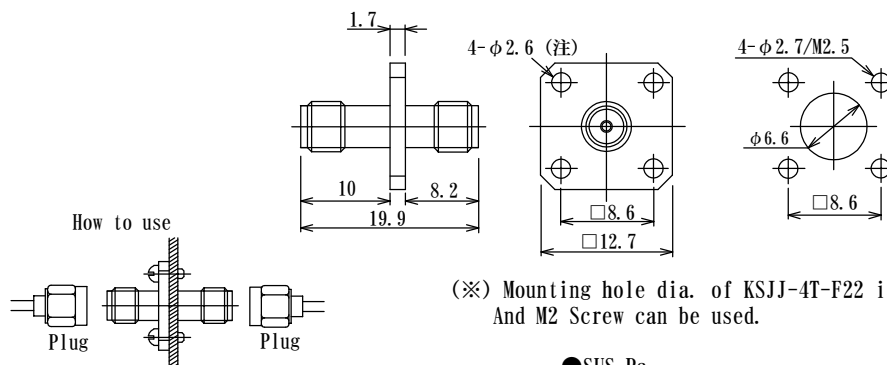

(※) Mounting hole dia. of KSJJ-4T-F22 is φ2.2mm.  
And M2 Screw can be used.

●SUS Pa

## KS Connectors DC~35GHz

### Panel Feedthrough Launcher

#### Jacks

KSJF-L104F30G  
KSJF-L104F50G

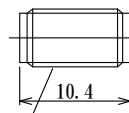

1/4-36UNS-2A

Socket pin inside  
 $\phi 0.3$  or  $\phi 0.5$

Part No.	Applicable Socket dia.	Remarks
KSJF-L104F30G	for $\phi 0.3$ mm	Launcher
KSJF-L104F50G	for $\phi 0.5$ mm	-

●SUS Au

### Flange Mount Jack Launcher

#### KSJRF-2BT

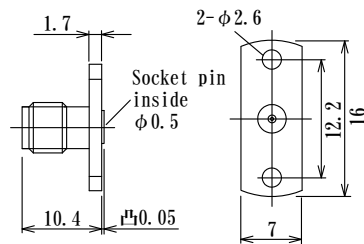

●SUS Au

#### KSJRF-4BT

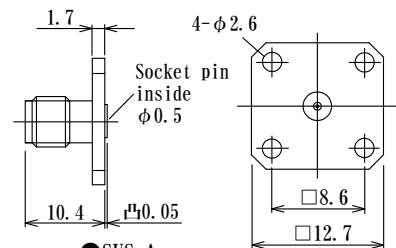

●SUS Au

#### KSJRF-F30P-2BT

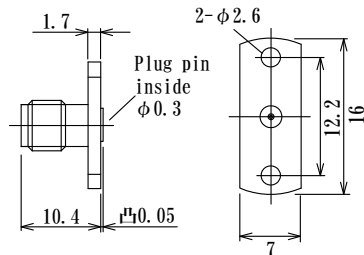

●SUS Au

#### KSJRF-F30P-4BT

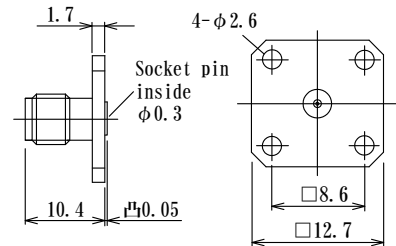

●SUS Au

### Bead Launcher式 How to use

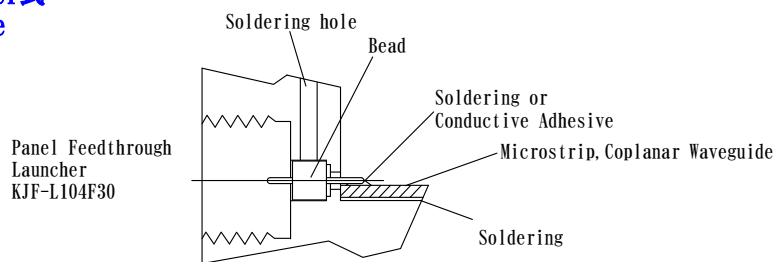

### Bead Launcher式 How to use

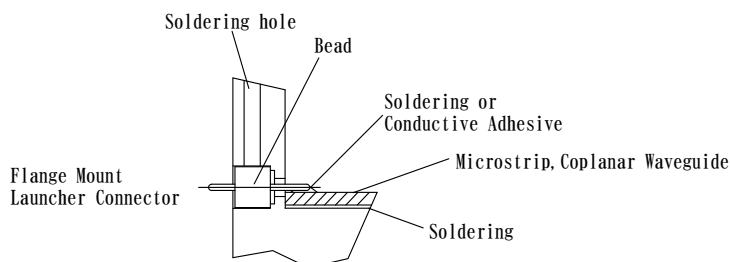

\* mark product is made only upon order.

## KS Connectors DC~35GHz

### Panel Feedthrough beads

#### 7BEAD-F30-L32H

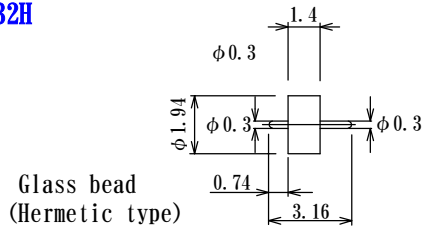

### Pin Terminals

#### MP-F30L32

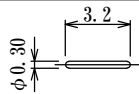

Round Terminal

Au plating over Ni

#### MP-F31F25L419

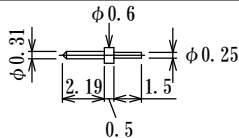

Round Terminal

Au plating over Ni

#### MP-T25F50L419

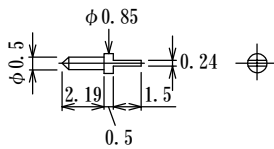

Tab Terminal

Au plating over Ni

#### MP-F25F50L419

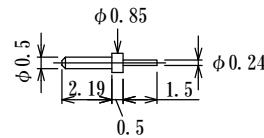

Round Terminal

Au plating over Ni

How to use

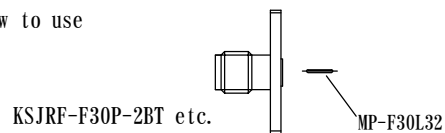

### PCB End Launch, Jacks, $\phi 0.5\text{mm}$ rear socket pin inside

- KS-EL-T08
- KS-EL-T10
- KS-EL-T12
- KS-EL-T16
- KS-EL-T32

※) The pin terminal is required.

Part No.	PCB thickness
KS-EL-T08	0.8mm
KS-EL-T10	1.0mm
KS-EL-T12	1.2mm
KS-EL-T16	1.6mm
KS-EL-T32	3.2mm

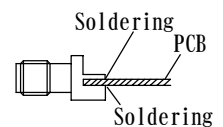
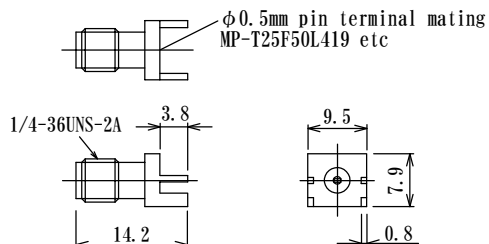

Material & Finish : Brass, Au plating over Ni

\* mark product is made only upon order.