

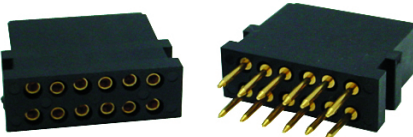

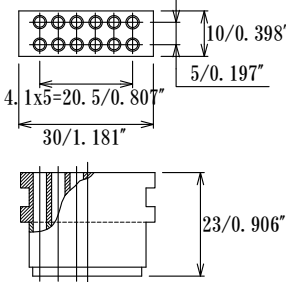

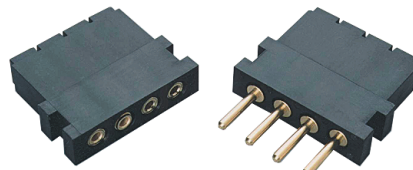
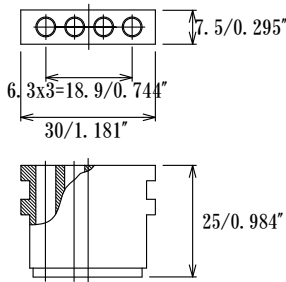

High Current Module UJC Series

<p>ϕ1.2 module 12pin max Current rating : 6A</p> <p>Insulator P/N: UJC-M11X12-T250-AB</p>   <p>Dielectric strength : 1500V Wire outer dia. max : ϕ1.9</p>			<p>ϕ2.0 module 4pin max Current rating : 18A</p> <p>Insulator P/N: UJC-M20X4-T250</p>   <p>Dielectric strength : 1800V</p>		
Pin type	Socket pin P/N	Plug pin P/N	Pin type	Socket pin P/N	Plug pin P/N
Solder	UJCS12-F2-G	UJCP12-F2-G (Pre mating pin)	Solder	UJCS20-23LG-RG	UJCP20-95LG-RG UJCP20-140LG-RG (Pre mating pin)
Gold plating			Gold plating		
Crimp	UJCS12-24LG-CR	UJCP12-95LG-CR UJCP12-140LG-CR (Pre mating pin)	Crimp	UJCS20-23LAG-CR	UJCP20-95LAG-CR UJCP20-140LAG-CR (Pre mating pin)
Silver plating			Silver plating		

Materials

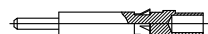
Socket pin

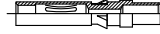
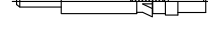
Louwer: Beryllium Copper, Heat treated
Gold Plated over Nickel plating
Sleeve: Brass, Gold Plating over Nickel plating

Plug pin

: Brass, Gold Plating over Nickel plating

Insulator

: PBT glass filled or PPs, black, UL94V-0

*Please call factory about followings
Crimping tool + Locator
Pin Removal too

Note:

Current rating value is in case of a single pole.
When using multi number of pins, the current rating decreases.

**High Current Module $\phi 3.0\text{mm}/0.118''$ 3pin max
UJC Series**

$\phi 3.0\text{mm}/0.118''$ module
Current rating : 30A at 25°C
Insulator P/N:
UJC-M30X3-T250

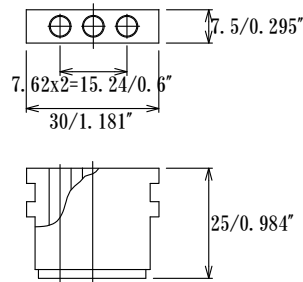

Dielectric strength : 1200V

Pin type	Socket pin P/N	Plug pin P/N
Soldering	<p>UJCS30-23LG-RG</p>	<p>UJCP30-95LG-RG UJCP30-140LG-RG (Pre mating pin)</p>
Gold plating		
Crimping	<p>UJCS30-23LAG-CR</p>	<p>UJCP30-95LAG-CR UJCP30-140LAG-CR (Pre mating pin)</p>
Silver plating		

**High Current Module $\phi 6.0\text{mm}/0.236''$ 2pin
UJC Series**

$\phi 6.0\text{mm}/0.236''$ module
Current rating : 65A at 25°C
Insulator P/N:
UJC-M40X2-T250-3

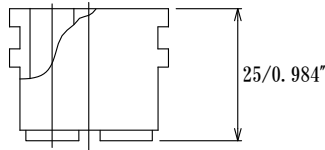
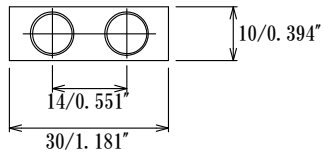
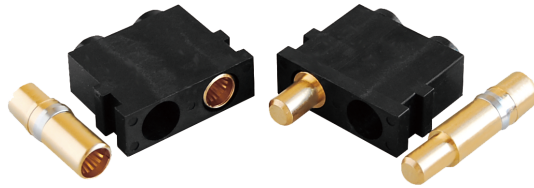

Dielectric strength : 1500V

Pin type	Socket pin P/N	Plug pin P/N																																
Crimping	<table border="1"> <thead> <tr> <th>P/N</th> <th>ϕA</th> <th>ϕB</th> <th>AWG#</th> </tr> </thead> <tbody> <tr> <td>UJCS60-31LG-CR140</td> <td>7.5/0.295"</td> <td>5.3/0.209"</td> <td>6</td> </tr> <tr> <td>UJCS60-31LG-CR080</td> <td>6.5/0.256"</td> <td>4.1/0.161"</td> <td>8</td> </tr> <tr> <td>UJCS60-31LG-CR035</td> <td>4.5/0.177"</td> <td>2.9/0.114"</td> <td>12</td> </tr> </tbody> </table>	P/N	ϕA	ϕB	AWG#	UJCS60-31LG-CR140	7.5/0.295"	5.3/0.209"	6	UJCS60-31LG-CR080	6.5/0.256"	4.1/0.161"	8	UJCS60-31LG-CR035	4.5/0.177"	2.9/0.114"	12	<table border="1"> <thead> <tr> <th>P/N</th> <th>ϕA</th> <th>ϕB</th> <th>AWG#</th> </tr> </thead> <tbody> <tr> <td>UJCP60-115LG-CR140</td> <td>7.5/0.295"</td> <td>5.3/0.209"</td> <td>6</td> </tr> <tr> <td>UJCP60-115LG-CR080</td> <td>6.5/0.256"</td> <td>4.1/0.161"</td> <td>8</td> </tr> <tr> <td>UJCP60-115LG-CR035</td> <td>4.5/0.177"</td> <td>2.9/0.114"</td> <td>12</td> </tr> </tbody> </table>	P/N	ϕA	ϕB	AWG#	UJCP60-115LG-CR140	7.5/0.295"	5.3/0.209"	6	UJCP60-115LG-CR080	6.5/0.256"	4.1/0.161"	8	UJCP60-115LG-CR035	4.5/0.177"	2.9/0.114"	12
	P/N	ϕA	ϕB	AWG#																														
	UJCS60-31LG-CR140	7.5/0.295"	5.3/0.209"	6																														
	UJCS60-31LG-CR080	6.5/0.256"	4.1/0.161"	8																														
UJCS60-31LG-CR035	4.5/0.177"	2.9/0.114"	12																															
P/N	ϕA	ϕB	AWG#																															
UJCP60-115LG-CR140	7.5/0.295"	5.3/0.209"	6																															
UJCP60-115LG-CR080	6.5/0.256"	4.1/0.161"	8																															
UJCP60-115LG-CR035	4.5/0.177"	2.9/0.114"	12																															
Gold plating																																		
		<p>Please call factory about followings Crimping tool Pin Removal tool</p>																																