

N Series Socket Pins

Contact Resistance: less than 15mΩ
 Acceptable Plug Range: $\phi 0.52 \sim \phi 0.30$
 Material Sleeve: Brass Gold over Ni plated, or Tin over Ni plated
 Contact: Beryllium-Copper Gold over Ni plated

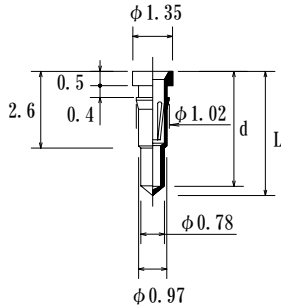

Why Silicone Seal Option?
 ○ Usable at inferior environment.
 ○ Specify when you wish to maintain higher reliability by means of half-closing contact point from outside environment.

Silicone Seal

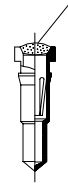

NSVS0020-GG
NSVS0030-GG
NSVS0040-GG

Parts Number	Length L	Depth d
NSV0020-GG	4.2	3.9
NSV0030-GG	5.0	4.1
NSV0040-GG	7.6	5.5

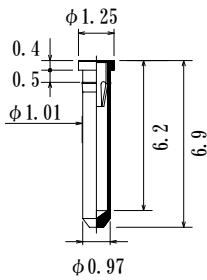

NSF0035-GG

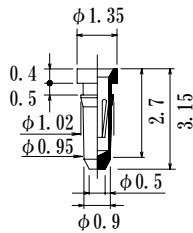

NSF0010-GG

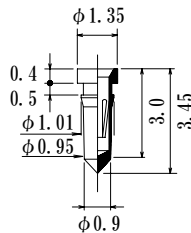

NSF11-GG

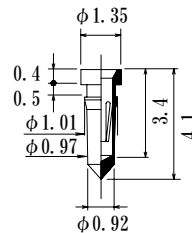

NSF12-GG

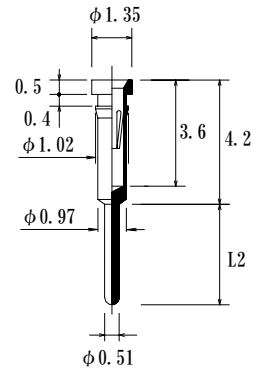

Parts Number	Length L2
N0010-GG	3.4
N0012-GG	2.8
N0014-GG	2.0

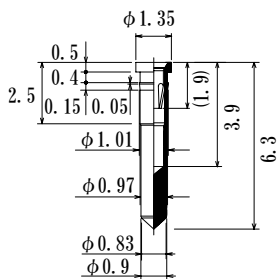

NSV0060-GG

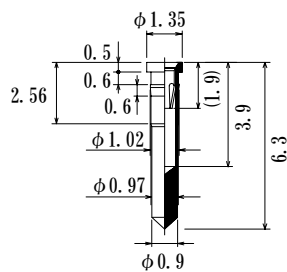

NSV0063P-GG

*Board thickness should be more than 0.7mm in case of press fitting

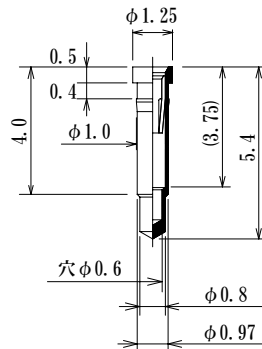

NSK55-GG

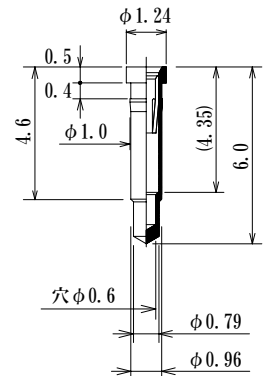

NSK60-GG

N Series Socket Pins

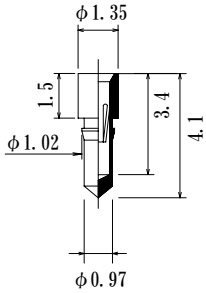

NSF15-GG

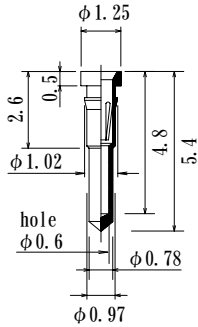

NS55-GG

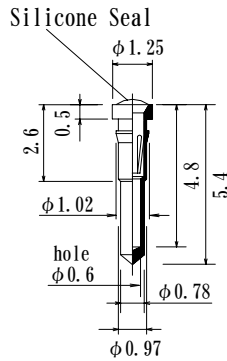

NS55-SGG

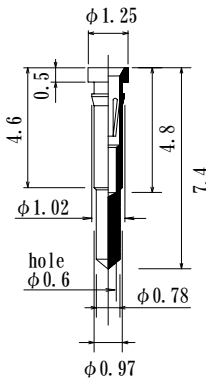

NS75-GG

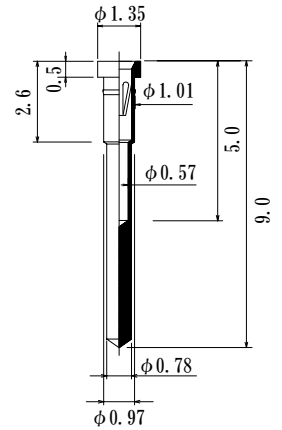

NC090-RL-GG

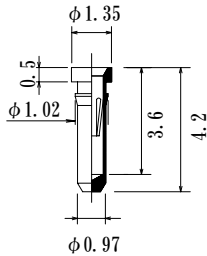

NS0010-GG

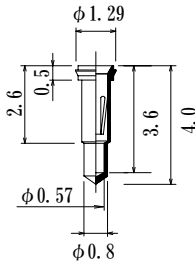

NT22-GG

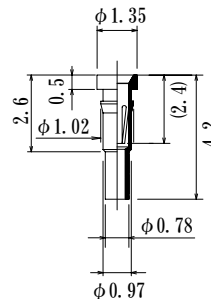

NSP15-GG

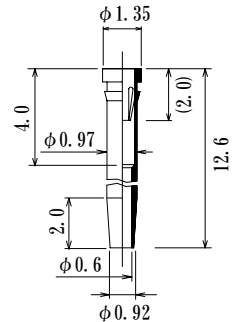

NSP126-GG

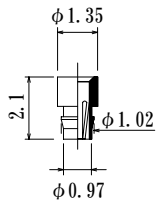

Thru hole
NSP11-GG

Cable Crimping Plug Pins

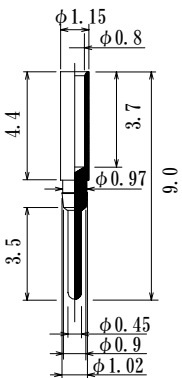

MP-WS100-1

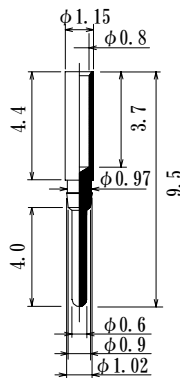

MP-WS100-2

Cable Crimping Socket Pins

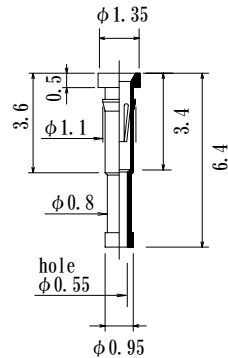

NLPS064-GG-A
 AWG28 for Twisted Wire

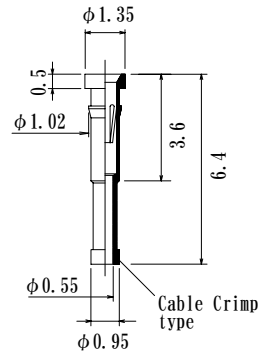

NLPS064-GG
 Compatible Cables
 AWG#28~#30



N Series Socket Pins

Contact Resistance: less than 15mΩ
 Acceptable Plug Range: $\phi 0.52 \sim \phi 0.30$
 Material Sleeve: Brass Gold over Ni plated, or Tin over Ni plated
 Contact: Beryllium Copper, Gold over Ni plated

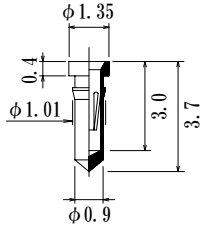

NSF18-GG

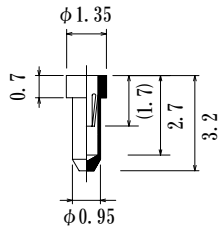

NSF20-GG

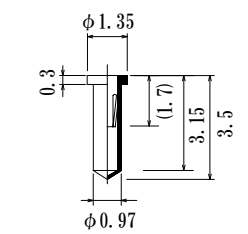

Acceptable Plug: $\phi 0.40\text{max}$

NSF19-GG

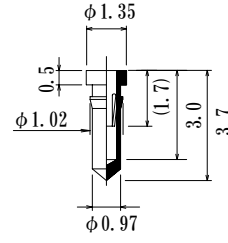

RN0013-GG

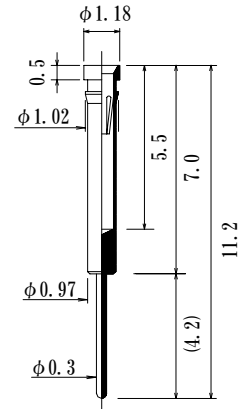

NA10-GG

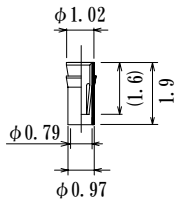

NZP19-GG

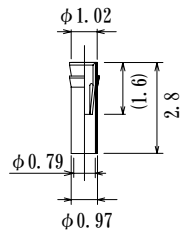

NZP28-GG

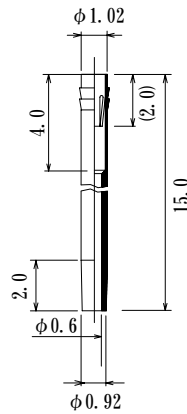

NZP10-GG

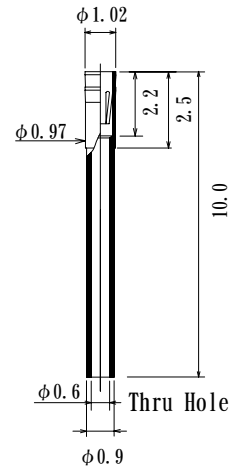

NZP100-GG

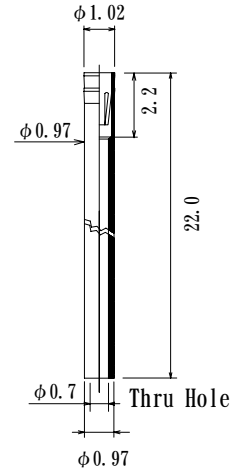

NZP220-GG

NY Series Socket pins

Contact Resistance: less than 15mΩ
 Acceptable Plug Range: $\phi 0.30 \sim \phi 0.40\text{mm}$
 Material Sleeve: Brass Gold over Ni plated, or Tin over Ni plated
 Contact: Beryllium Copper, Gold over Ni plated

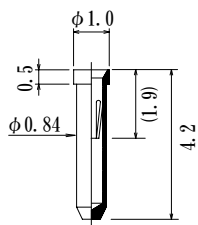

NY42-GG
Low Force

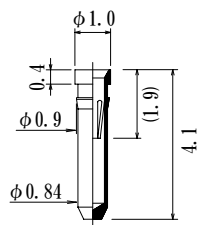

NY42H0-GG
Low Force

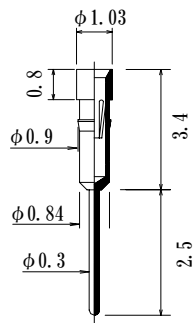

NZM10-GG
Low Force