

## φ2 Right Angle Socket

\*It enables to check an electric circuit with inserting a probe pin.

Applicable Plug Diameter  
φ 2.0mm

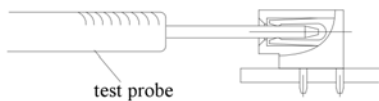

How to order:  
**M-CHK20-SUMI-RED**

insulator color  
RED: red  
BLK: black

### Specifications

Current rating: 5A max  
Insulation resistance: 500MΩ min  
Dielectric strength: 1000V AC/DC 1minute  
Operating temperature: -25°C ~ +85°C  
Applicable Plug Diameter: φ 2.0mm

### Material

Contact: fork type phosphor bronze  
Gold plating over Ni  
Insulator: Glass Fiber reinforced PBT

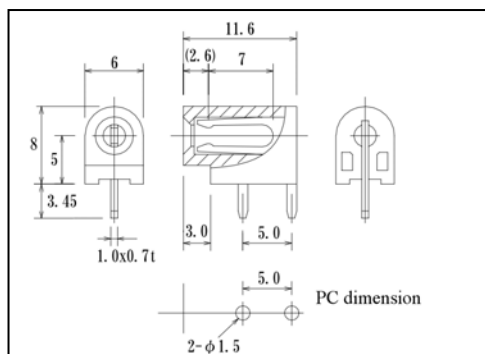

## Surface Mounting Socket Pin

### Specifications

Dielectric Strength: AC700V RMS 1minute  
Insulation resistance: 1000MΩ  
Contact resistance: 15mΩ max  
Current rating: 1.0A  
Operating temperature: -55°C ~ +150°C  
(Gold plated contact)  
Applicable Plug Diameter: φ 0.40mm ~ φ 0.50mm  
(max length 2.6mm)

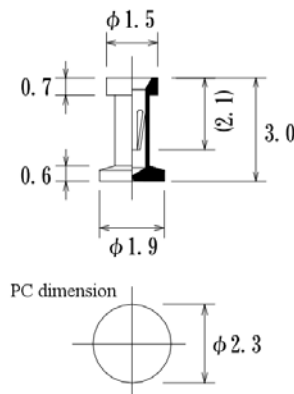

Mounting Instruction

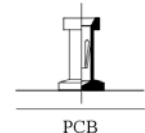

**SMN10-GT**

## Pin and Cable Assembly

### Specifications

Dielectric Strength: AC700V RMS 1minute  
Insulation resistance: 1000MΩ  
Contact resistance: 15mΩ max  
Current rating: 1.0A  
Operating temperature: -55°C ~ +150°C

### Material

phosphor bronze, Gold plating over Ni

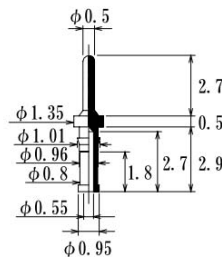

**MP-WS500**



Cable and Crimp Tool  
P/N : TOOL-MPWS-500  
with Locator

Crimping Cable or Soldering  
\*You can make plug cables.